

# 揭阳市榕城区凤美街道初级中学（原揭阳空港经济区凤美街道初级中学）

## “三旧”改造项目拟征收土地用地界址红线图

单位：米

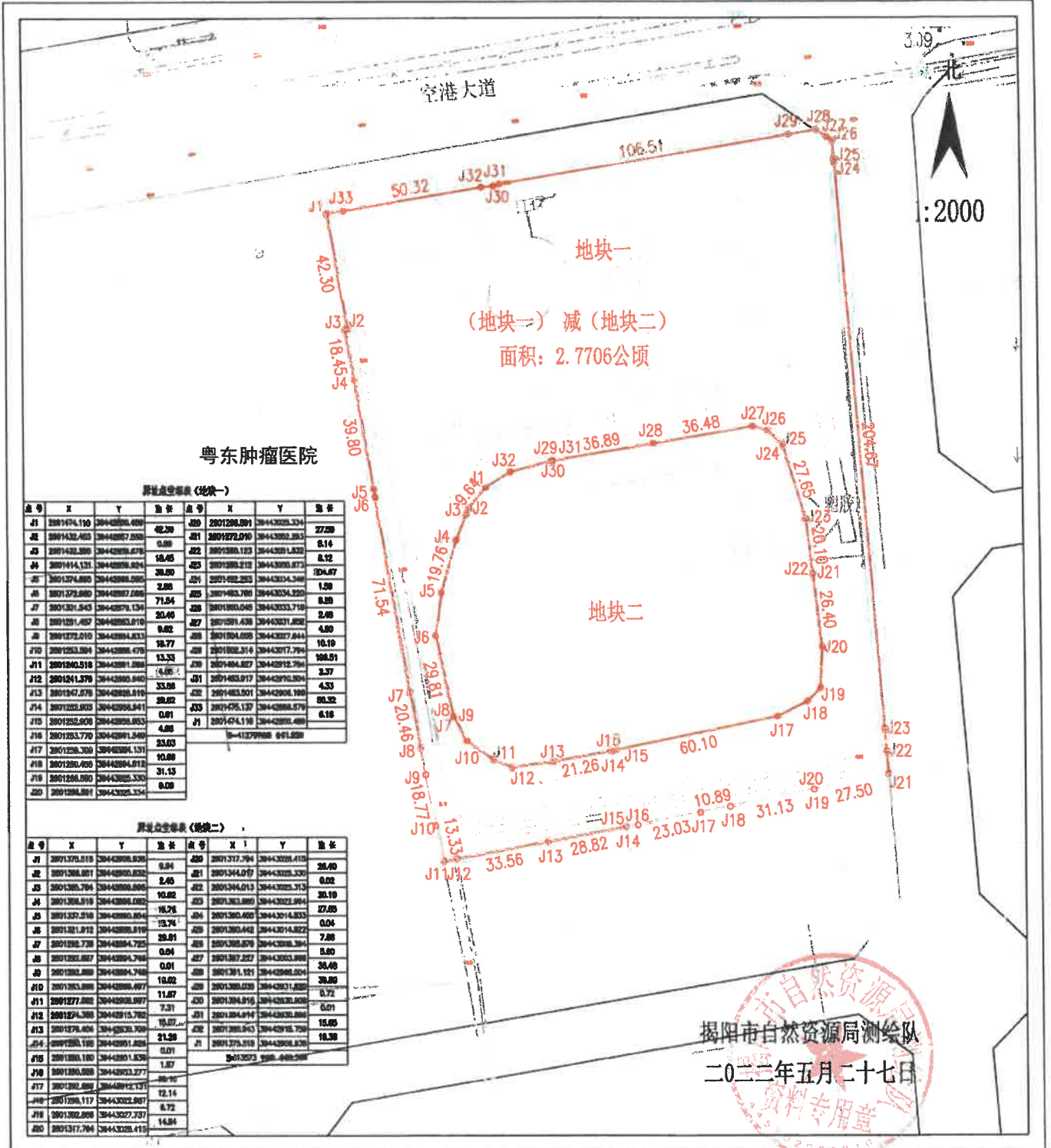

界址点坐标表 (地块一)

点号	X	Y	边长	点号	X	Y	边长
J1	2801474.110	28442888.488	42.30	J29	2801286.891	28443028.324	27.88
J2	2801432.403	28442887.288	0.88	J30	2801272.070	28443028.383	27.88
J3	2801432.395	28442888.678	18.45	J31	2801288.123	28443028.133	0.14
J4	2801474.131	28442888.824	38.80	J32	2801288.218	28443028.873	104.67
J5	2801374.880	28442888.080	2.88	J33	2801482.283	28443034.348	1.88
J6	2801372.880	28442887.288	71.54	J20	2801483.780	28443034.220	0.88
J7	2801381.843	28442878.134	39.80	J21	2801480.048	28443033.719	2.48
J8	2801281.887	28442883.810	0.82	J22	2801481.438	28443031.882	4.80
J9	2801272.810	28442884.833	18.77	J23	2801484.028	28443027.844	4.80
J10	2801253.884	28442888.478	13.33	J24	2801482.814	28443017.794	18.18
J11	2801240.818	28442881.884	4.88	J25	2801484.827	28442912.784	188.81
J12	2801241.878	28442888.840	33.88	J26	2801483.017	28442912.884	2.37
J13	2801247.878	28442888.818	38.82	J27	2801483.801	28442908.188	4.33
J14	2801223.803	28442888.841	0.81	J28	2801478.137	28442888.878	88.32
J15	2801223.808	28442888.883	4.88	J29	2801474.118	28442888.488	0.18
J16	2801223.778	28442881.848	25.88				
J17	2801228.788	28442884.131	18.88				
J18	2801288.888	28442884.818	31.13				
J19	2801288.888	28442888.330	0.88				
J20	2801288.881	28443028.324					

界址点坐标表 (地块二)

点号	X	Y	边长	点号	X	Y	边长
J1	2801375.818	28442888.828	8.84	J20	2801317.784	28443028.418	36.48
J2	2801388.881	28442888.838	2.48	J21	2801344.817	28443028.330	0.82
J3	2801385.784	28442888.888	10.82	J22	2801344.813	28443028.313	28.18
J4	2801388.818	28442888.882	18.78	J23	2801383.888	28443022.884	27.88
J5	2801387.818	28442888.884	18.78	J24	2801388.488	28443014.833	0.84
J6	2801381.812	28442888.818	18.74	J25	2801383.482	28443014.822	7.88
J7	2801388.738	28442884.728	0.84	J26	2801388.878	28443018.384	8.88
J8	2801388.887	28442884.748	0.84	J27	2801387.227	28443018.888	36.48
J9	2801388.888	28442884.748	18.82	J28	2801381.121	28442888.884	38.88
J10	2801383.888	28442888.887	11.87	J29	2801388.828	28442881.882	0.72
J11	2801277.888	28442888.887	7.31	J30	2801384.818	28442888.888	18.88
J12	2801274.388	28442881.788	15.87	J31	2801384.814	28442888.888	0.81
J13	2801278.484	28442888.788	18.87	J32	2801388.843	28442888.788	18.88
J14	2801288.188	28442881.888	0.81	J33	2801375.818	28442888.828	18.38
J15	2801288.188	28442881.838	1.87				
J16	2801288.888	28442883.277	88.18				
J17	2801288.888	28442881.131	12.14				
J18	2801288.117	28443022.887	0.72				
J19	2801288.888	28443027.237	14.84				
J20	2801317.784	28443028.418					

国家大地2000