

揭阳市榕城区2025年度第三十七批次城镇建设用地图

单位：米

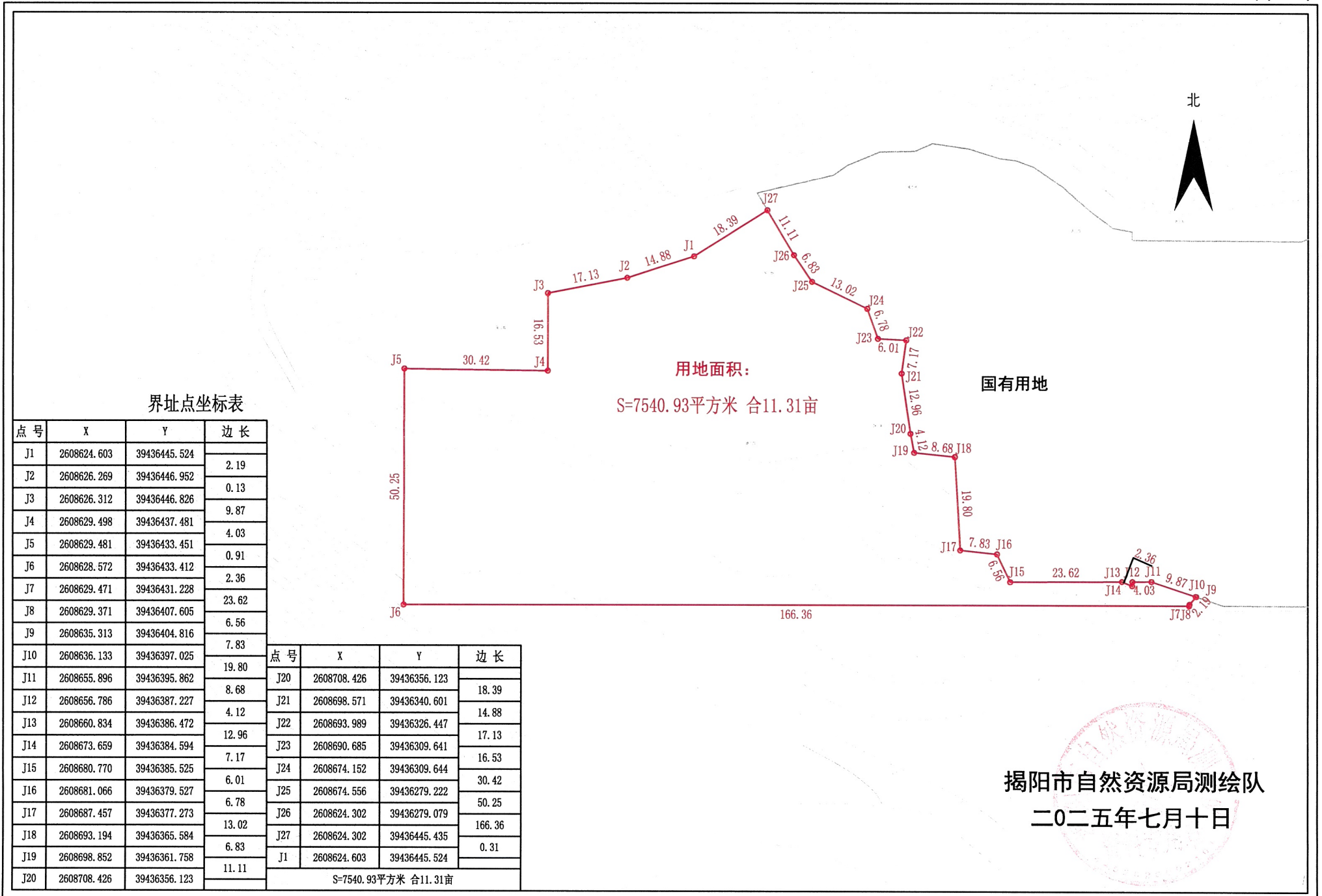

界址点坐标表

点号	X	Y	边长
J1	2608624.603	39436445.524	2.19
J2	2608626.269	39436446.952	0.13
J3	2608626.312	39436446.826	9.87
J4	2608629.498	39436437.481	4.03
J5	2608629.481	39436433.451	0.91
J6	2608628.572	39436433.412	2.36
J7	2608629.471	39436431.228	23.62
J8	2608629.371	39436407.605	6.56
J9	2608635.313	39436404.816	7.83
J10	2608636.133	39436397.025	19.80
J11	2608655.896	39436395.862	8.68
J12	2608656.786	39436387.227	4.12
J13	2608660.834	39436386.472	12.96
J14	2608673.659	39436384.594	7.17
J15	2608680.770	39436385.525	6.01
J16	2608681.066	39436379.527	6.78
J17	2608687.457	39436377.273	13.02
J18	2608693.194	39436365.584	6.83
J19	2608698.852	39436361.758	11.11
J20	2608708.426	39436356.123	18.39

点号	X	Y	边长
J20	2608708.426	39436356.123	18.39
J21	2608698.571	39436340.601	14.88
J22	2608693.989	39436326.447	17.13
J23	2608690.685	39436309.641	16.53
J24	2608674.152	39436309.644	30.42
J25	2608674.556	39436279.222	50.25
J26	2608624.302	39436279.079	166.36
J27	2608624.302	39436445.435	0.31
J1	2608624.603	39436445.524	0.31

S=7540.93平方米 合11.31亩

揭阳市自然资源局测绘队
二〇二五年七月十日