

广东省揭阳市海洋生态修复项目（榕江口区域）种养殖清退勘测范围图

单位：米

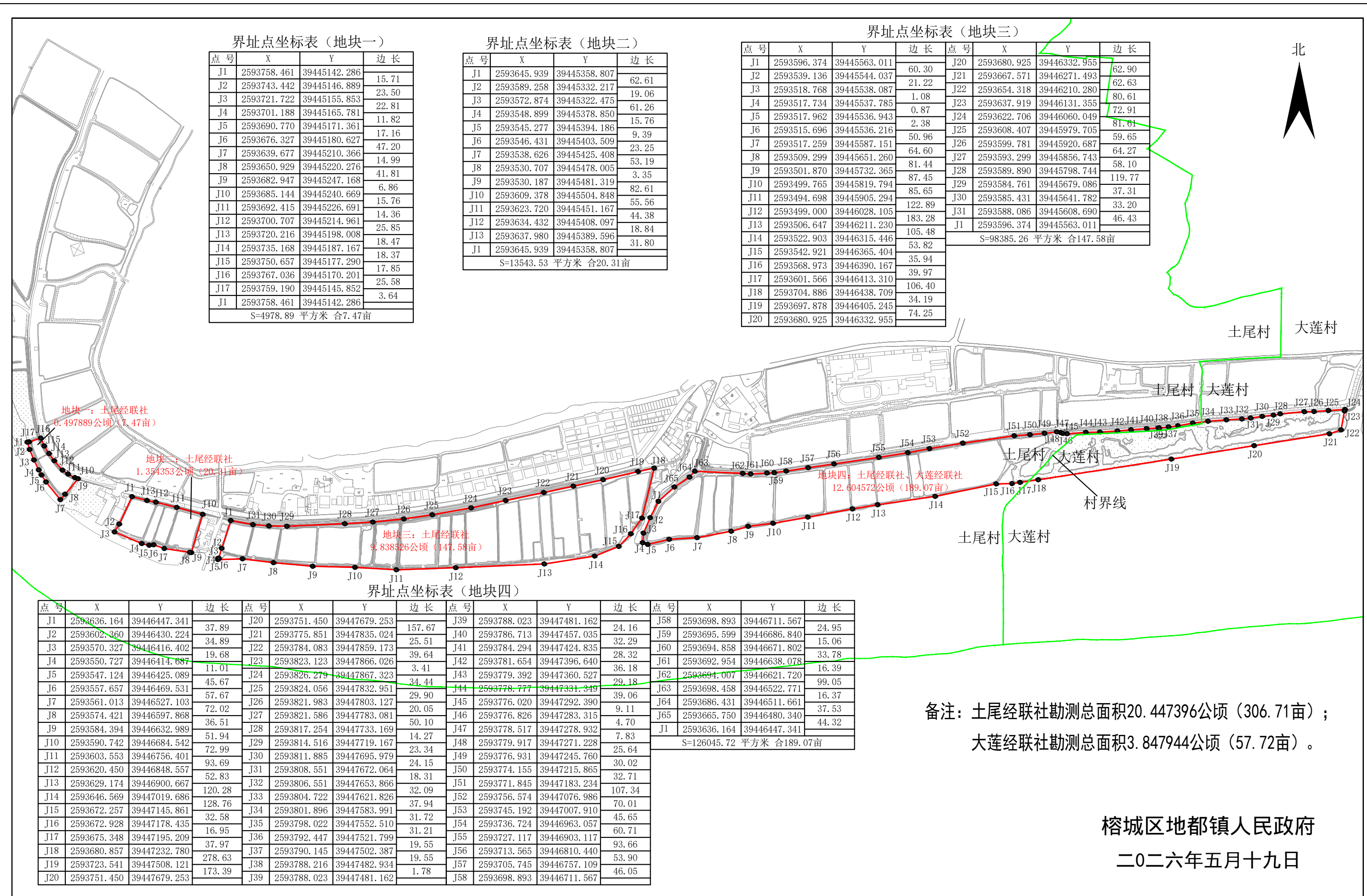

界址点坐标表（地块一）

点号	X	Y	边长
J1	2593758.461	39445142.286	15.71
J2	2593743.442	39445146.889	23.50
J3	2593721.722	39445155.853	22.81
J4	2593701.188	39445165.781	11.82
J5	2593690.770	39445171.361	17.16
J6	2593676.327	39445180.627	47.20
J7	2593639.677	39445210.366	14.99
J8	2593650.929	39445220.276	41.81
J9	2593682.947	39445247.168	6.86
J10	2593685.144	39445240.669	15.76
J11	2593692.415	39445226.691	14.36
J12	2593700.707	39445214.961	25.85
J13	2593720.216	39445198.008	18.47
J14	2593735.168	39445187.167	18.37
J15	2593750.657	39445177.290	17.85
J16	2593767.036	39445170.201	25.58
J17	2593759.190	39445145.852	3.64
J1	2593758.461	39445142.286	
S=4978.89 平方米 合7.47亩			

界址点坐标表（地块二）

点号	X	Y	边长
J1	2593645.939	39445358.807	62.61
J2	2593589.258	39445332.217	19.06
J3	2593572.874	39445322.475	61.26
J4	2593548.899	39445378.850	15.76
J5	2593545.277	39445394.186	9.39
J6	2593546.431	39445403.509	23.25
J7	2593538.626	39445425.408	53.19
J8	2593530.707	39445478.005	3.35
J9	2593530.187	39445481.319	82.61
J10	2593609.378	39445504.848	55.56
J11	2593623.720	39445451.167	44.38
J12	2593634.432	39445408.097	18.84
J13	2593637.980	39445389.596	31.80
J1	2593645.939	39445358.807	
S=13543.53 平方米 合20.31亩			

界址点坐标表（地块三）

点号	X	Y	边长
J1	2593596.374	39445563.011	60.30
J2	2593539.136	39445544.037	21.22
J3	2593518.768	39445538.087	1.08
J4	2593517.734	39445537.785	0.87
J5	2593517.962	39445536.943	2.38
J6	2593515.696	39445536.216	50.96
J7	2593517.259	39445587.151	64.60
J8	2593509.299	39445651.260	81.44
J9	2593501.870	39445732.365	87.45
J10	2593499.765	39445819.794	85.65
J11	2593494.698	39445905.294	122.89
J12	2593499.000	39446028.105	183.28
J13	2593506.647	39446211.230	105.48
J14	2593522.903	39446315.446	53.82
J15	2593542.921	39446365.404	35.94
J16	2593568.973	39446390.167	39.97
J17	2593601.566	39446413.310	106.40
J18	2593704.886	39446438.709	34.19
J19	2593697.878	39446405.245	74.25
J20	2593680.925	39446332.955	62.90
J21	2593667.571	39446271.493	62.63
J22	2593654.318	39446210.280	80.61
J23	2593637.919	39446131.355	72.91
J24	2593622.706	39446060.049	81.61
J25	2593608.407	39445979.705	59.65
J26	2593599.781	39445920.687	64.27
J27	2593593.299	39445856.743	58.10
J28	2593589.890	39445798.744	119.77
J29	2593584.761	39445679.086	37.31
J30	2593585.431	39445641.782	33.20
J31	2593588.086	39445608.690	46.43
J1	2593596.374	39445563.011	
S=98385.26 平方米 合147.58亩			

界址点坐标表（地块四）

点号	X	Y	边长
J1	2593636.164	39446447.341	37.89
J2	2593602.360	39446430.224	34.89
J3	2593570.327	39446416.402	19.68
J4	2593550.727	39446414.687	11.01
J5	2593547.124	39446425.089	45.67
J6	2593557.657	39446469.531	57.67
J7	2593561.013	39446527.103	72.02
J8	2593574.421	39446597.868	36.51
J9	2593584.394	39446632.989	51.94
J10	2593590.742	39446684.542	72.99
J11	2593603.553	39446756.401	93.69
J12	2593620.450	39446848.557	52.83
J13	2593629.174	39446900.667	120.28
J14	2593646.569	39447019.686	128.76
J15	2593672.257	39447145.861	32.58
J16	2593672.928	39447178.435	16.95
J17	2593675.348	39447195.209	37.97
J18	2593680.857	39447232.780	278.63
J19	2593723.541	39447508.121	173.39
J20	2593751.450	39447679.253	157.67
J21	2593775.851	39447835.024	25.51
J22	2593784.083	39447859.173	39.64
J23	2593823.123	39447866.026	3.41
J24	2593826.279	39447867.323	34.44
J25	2593824.056	39447832.951	29.90
J26	2593821.983	39447803.127	20.05
J27	2593821.586	39447783.081	50.10
J28	2593817.254	39447733.169	14.27
J29	2593814.516	39447719.167	23.34
J30	2593811.885	39447695.979	24.15
J31	2593808.551	39447672.064	18.31
J32	2593806.551	39447653.866	32.09
J33	2593804.722	39447621.826	37.94
J34	2593801.896	39447583.991	31.72
J35	2593798.022	39447552.510	31.21
J36	2593792.447	39447521.799	19.55
J37	2593790.145	39447502.387	19.55
J38	2593788.216	39447482.934	1.78
J39	2593788.023	39447481.162	24.16
J40	2593786.713	39447457.035	32.29
J41	2593784.294	39447424.835	28.32
J42	2593781.654	39447396.640	36.18
J43	2593779.392	39447360.527	29.18
J44	2593778.777	39447331.349	39.06
J45	2593776.020	39447292.390	9.11
J46	2593776.826	39447283.315	4.70
J47	2593778.517	39447278.932	7.83
J48	2593779.917	39447271.228	25.64
J49	2593776.931	39447245.760	30.02
J50	2593774.155	39447215.865	32.71
J51	2593771.845	39447183.234	107.34
J52	2593756.574	39447076.986	70.01
J53	2593745.192	39447007.910	45.65
J54	2593736.724	39446963.057	60.71
J55	2593727.117	39446903.117	93.66
J56	2593713.565	39446810.440	53.90
J57	2593705.745	39446757.109	46.05
J58	2593698.893	39446711.567	24.95
J59	2593695.599	39446686.840	15.06
J60	2593694.858	39446671.802	33.78
J61	2593692.954	39446638.078	16.39
J62	2593694.007	39446621.720	99.05
J63	2593698.458	39446522.771	16.37
J64	2593686.431	39446511.661	37.53
J65	2593665.750	39446480.340	44.32
J1	2593636.164	39446447.341	
S=126045.72 平方米 合189.07亩			

备注：土尾经联社勘测总面积20.447396公顷（306.71亩）；
大莲经联社勘测总面积3.847944公顷（57.72亩）。

榕城区地都镇人民政府
二〇二六年五月十九日